

Technical Data Sheet

optibelt ALPHA LINEAR/V F3 groove free - ST

PU Flat Belt, Optionally with Fabric PAR,
Open-Ended / Endless Joined



Dimensions, Tolerances

Profile:	F3
Total thickness:	3.0 mm
Width tolerance:	±0.5 mm
Thickness tolerance:	±0.2 mm

Construction

Polyurethane:	Thermoplastic, 92 Shore A, black
Tension cord:	Steel, Ø 1.2 mm
Fabric, optional:	Polyamide, one-sided (PAR), black

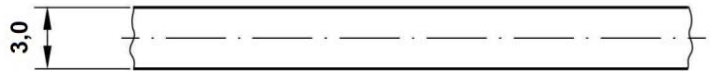

Cord-Zugkräfte, Mindestlänge, Riemengewicht

Riemenbreite ¹ b [mm]	15	25	30	40	50	75	100
F _{Br} [N], ALPHA LINEAR	10360	19000	22480	32240	43240	67440	89960
F _{zul} [N] ² , ALPHA LINEAR, ε _{zul} =0,55%	2590	4750	5620	8210	10810	16860	22490
F _{zul} [N] ² , ALPHA V	1295	2375	2810	4105	5405	8430	11245
Minimum length ALPHA V [mm]	-	700	-	-	900	900	900
Weight per meter [kg/m]	0.099	0.165	0.198	0.264	0.330	0.495	0.660

¹ Kleinere und Zwischenbreiten möglich ² Zulässige Zugkraft F_{zul} = 25% / 12.5% (ALPHA LINEAR / V) der Bruchkraft F_{Br} der Corde $c_{spez} = F_{zul} / \epsilon_{zul}$

Inside and outside idlers

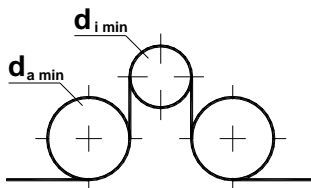

Minimum diameter of a plane inside idler: $d_{i \min} = 120 \text{ mm}$

Minimum diameter of a plane outside idler: $d_{a \min} = 150 \text{ mm}$